

TOWNSHIP OF LIMERICK REHABILITATION OF STEENBURG LAKE NORTH ROAD CONTRACT No 150-3794



 G.D. JEWELL ENGINEERING INC.
CONSULTING ENGINEERS

KINGSTON	BELLEVILLE	MISSISSAUGA
TEL: (613) 389-7250	TEL: (613) 969-1111	TEL: (905) 855-1592
FAX: (613) 389-2754	FAX: (613) 969-8988	FAX: (905) 855-5428
E-mail: kingston@jewelleng.ca	E-mail: info@jewelleng.ca	E-mail: mississauga@jewelleng.ca

TOLL FREE 1-800-966-4338
www.jewelleng.ca

STEENBURG LAKE NORTH ROAD

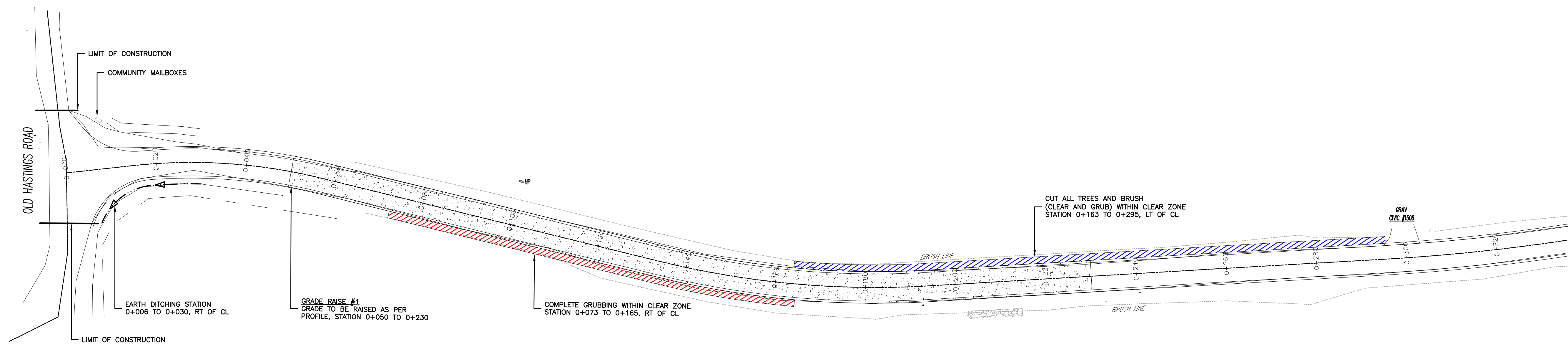
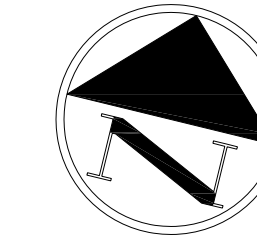

GENERAL NOTES:
 ALL INFORMATION TO BE VERIFIED ON SITE PRIOR TO COMMENCING ANY WORK. ANY DISCREPANCIES ARE TO BE REPORTED TO THE CONSULTING ENGINEER.
 ALL UTILITY LOCATIONS SHOWN ON THE DRAWINGS ARE APPROXIMATE. THE CONTRACTOR SHALL CONFIRM THE LOCATION ON SITE AND ASSUME ALL LIABILITY FOR DAMAGE TO ALL UTILITIES.
 EXCLUDING THE REMARKS AND DESCRIPTION PROVIDED FOR THIS PROJECT, NO OTHER ELEVATIONS ARE TO BE USED AS A REFERENCE ELEVATION FOR ANY PURPOSES.
METRIC NOTE:
 ALL DIMENSIONS SHOWN ARE IN METRES OR MILLIMETRES UNLESS OTHERWISE NOTED.
**** DRAWINGS ARE NOT TO BE SCALED ****

REVISIONS			
No.	Date	Description	By
0	12/13/2016	PRELIMINARY DRAWINGS FOR REVIEW	CB
1	03/24/2017	FINAL DESIGN FOR CLIENT REVIEW	CB

STEENBURG LAKE NORTH ROAD

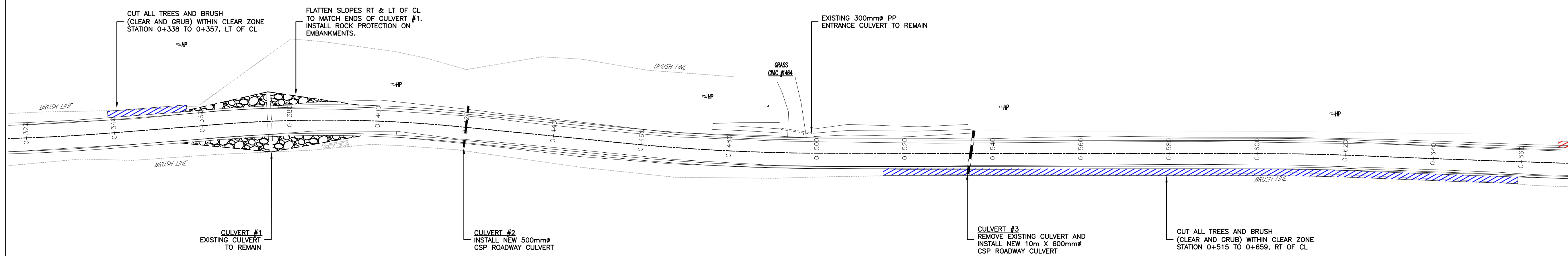
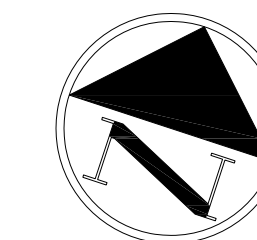

G.D. JEWELL ENGINEERING INC.
 CONSULTING ENGINEERS

BRISTOL TEL: (613) 396-7250 FAX: (613) 396-2754 Email: gdj@jewelleng.ca
BELLEVILLE TEL: (613) 969-1111 FAX: (613) 969-6996 Email: h@jewelleng.ca
MISSISSAUGA TEL: (905) 856-1502 FAX: (905) 856-5428 Email: h@jewelleng.ca

TOLL FREE 1-800-966-4338
 www.jewelleng.ca

TOWNSHIP OF LIMERICK
 REHABILITATION
 STEENBURG LAKE ROAD NORTH

Drawn by: CCG Project No: 150-3794
 Designed by: CB Date: MARCH 2016
 Checked by: CB Scale - Hor: 1:500 Vert:
 Approved by: CB Contract No: Drawing No: 1

STEENBURG LAKE NORTH ROAD

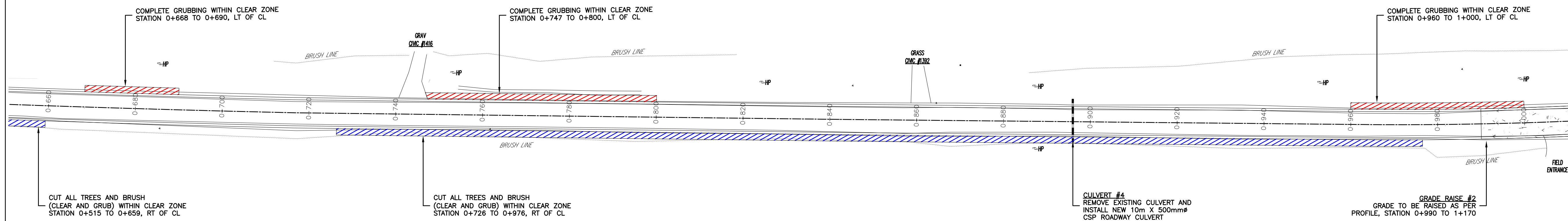
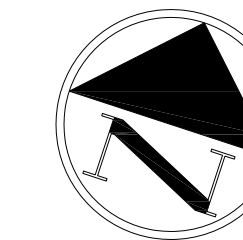

GENERAL NOTES:
 ALL INFORMATION TO BE VERIFIED ON SITE PRIOR TO COMMENCING ANY WORK. ANY DISCREPANCIES ARE TO BE REPORTED TO THE CONSULTING ENGINEER.
 ALL ELEVATIONS SHOWN ON THE DRAWINGS ARE APPROXIMATE. THE CONTRACTOR SHALL CONFIRM THE LOCATION ON SITE AND ASSUME ALL LIABILITY FOR DAMAGE TO ALL UTILITIES.
 EXCEPTING THE REMARKS AND DESCRIPTION PROVIDED FOR THIS PROJECT, NO OTHER ELEVATIONS ARE TO BE USED AS A REFERENCE ELEVATION FOR ANY PURPOSES.
METRIC NOTE:
 ALL DIMENSIONS SHOWN ARE IN METRES OR MILLIMETRES UNLESS OTHERWISE NOTED.
**** DRAWINGS ARE NOT TO BE SCALED ****

REVISIONS			
No.	Date	Description	By
0	12/13/2016	PRELIMINARY DRAWINGS FOR REVIEW	CB
1	03/24/2017	FINAL DESIGN FOR CLIENT REVIEW	CB

STEENBURG LAKE NORTH ROAD

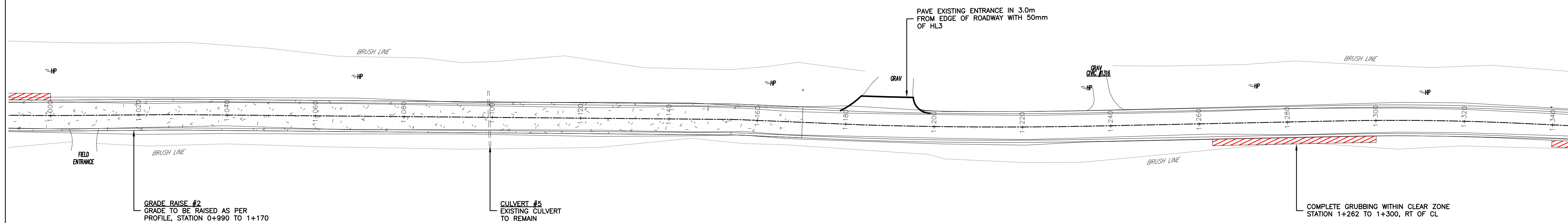
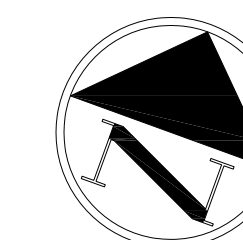

G.D. JEWELL ENGINEERING INC.
 CONSULTING ENGINEERS

WINGSTON TEL: (813) 386-7250 FAX: (813) 386-2754 Email: gajewell@jewelleng.ca
BELLEVILLE TEL: (813) 968-1111 FAX: (813) 968-6986 Email: hking@jewelleng.ca
MISSISSAUGA TEL: (905) 855-1552 FAX: (905) 855-5428 Email: hking@jewelleng.ca

TOLL FREE 1-800-966-4338
 www.jewelleng.ca

**TOWNSHIP OF LIMERICK
 REHABILITATION
 STEENBURG LAKE ROAD NORTH**

Drawn by: CCG Project No: 150-3794
 Date: MARCH 2016
 Checked by: CB Scale - Hor: 1:500 Vert:
 Approved by: CB Contract No: Drawing No: 2

STEENBURG LAKE NORTH ROAD

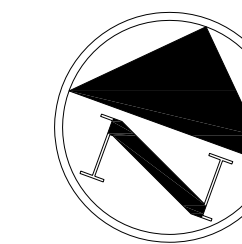

GENERAL NOTES:
 ALL INFORMATION TO BE VERIFIED ON SITE PRIOR TO COMMENCING ANY WORK. ANY DISCREPANCIES ARE TO BE REPORTED TO THE CONSULTANT IMMEDIATELY.
 ALL ELEVATIONS SHOWN ON THE DRAWINGS ARE APPROXIMATE. THE CONTRACTOR SHALL CONFIRM THE LOCATION ON SITE AND ASSUME ALL LIABILITY FOR DAMAGE TO ALL UTILITIES.
 EXCLUDING THE REMOVAL AND RECONSTRUCTION PROVIDED FOR THIS PROJECT, NO OTHER ELEVATIONS ARE TO BE USED AS A REFERENCE ELEVATION FOR ANY PURPOSES.
METRIC NOTE:
 ALL DIMENSIONS SHOWN ARE IN METRES OR MILLIMETRES UNLESS OTHERWISE NOTED.
**** DRAWINGS ARE NOT TO BE SCALED ****

REVISIONS			
No.	Date	Description	By
0	12/13/2016	PRELIMINARY DRAWINGS FOR REVIEW	CB
1	03/24/2017	FINAL DESIGN FOR CLIENT REVIEW	CB

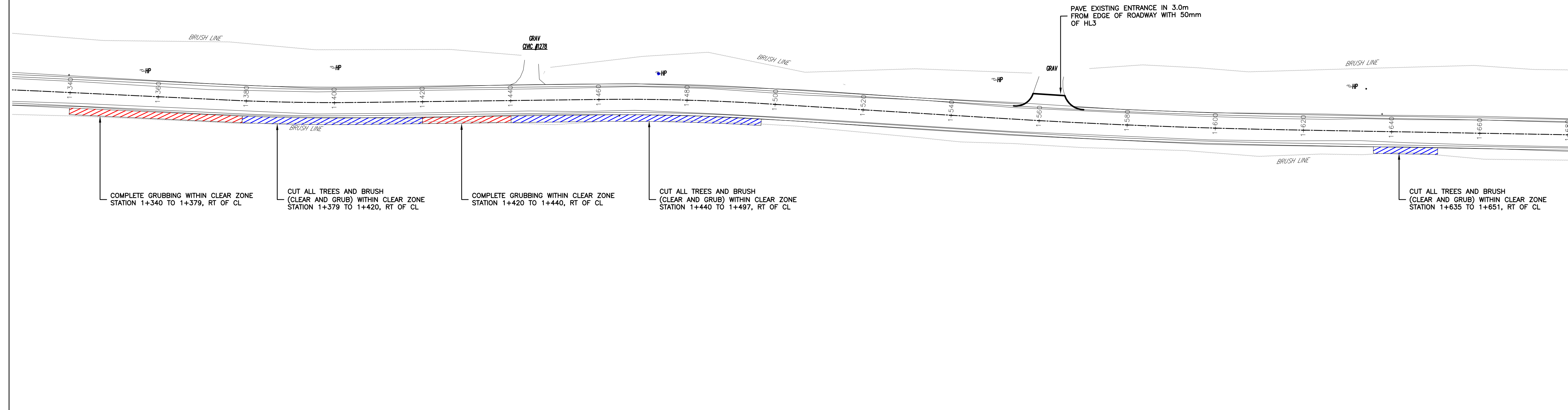

STEENBURG LAKE NORTH ROAD

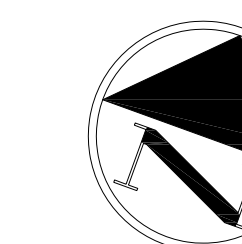

G.D. JEWELL ENGINEERING INC.
 CONSULTING ENGINEERS

KINGSTON TEL: (613) 396-7250 FAX: (613) 396-2754 Email: gkjewell@jewelleng.ca
BELLEVILLE TEL: (613) 966-1111 FAX: (613) 966-4986 Email: h.kingston@jewelleng.ca
MISSISSAUGA TEL: (905) 856-1552 FAX: (905) 856-5428 Email: h.mississauga@jewelleng.ca

TOLL FREE 1-800-966-4338
 www.jewelleng.ca

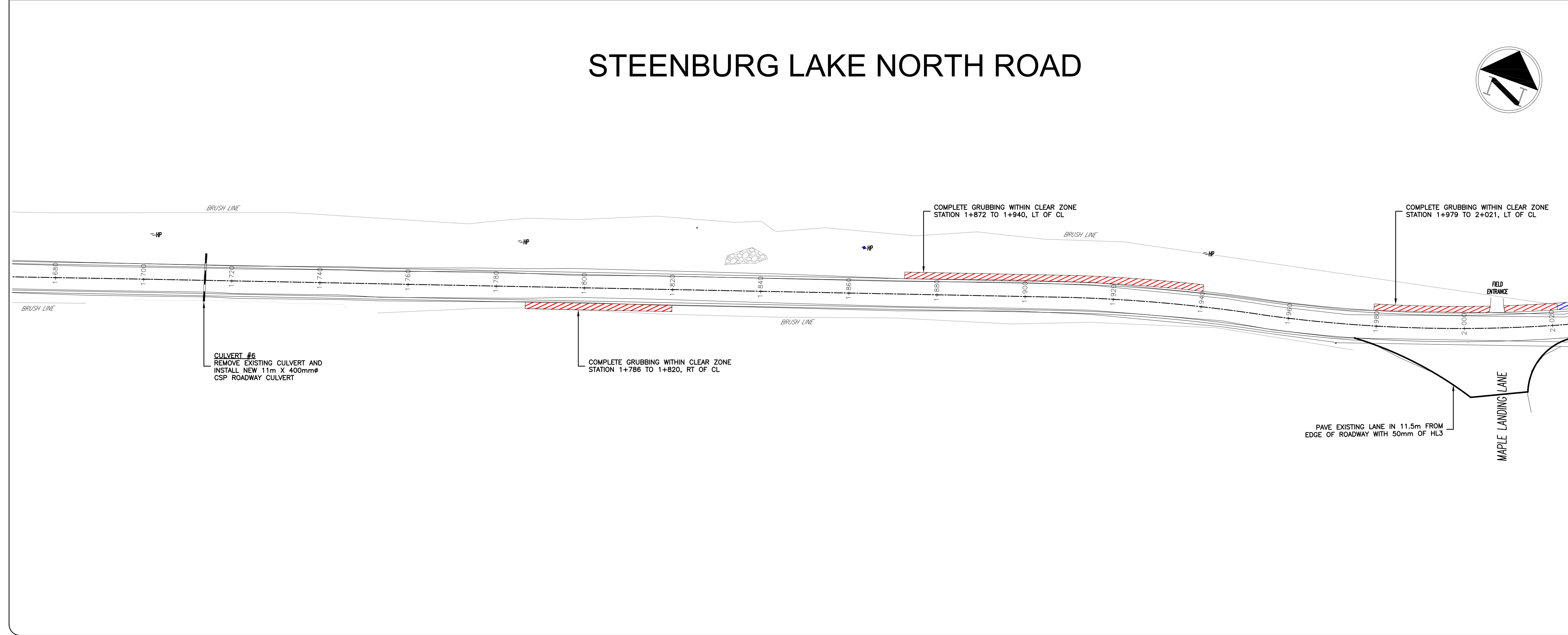

**TOWNSHIP OF LIMERICK
 REHABILITATION
 STEENBURG LAKE ROAD NORTH**

Drawn by: CCG Project No: 150-3794
 Checked by: CB Date: MARCH 2016
 Approved by: CB Contract No: Drawing No: 3

STEENBURG LAKE NORTH ROAD

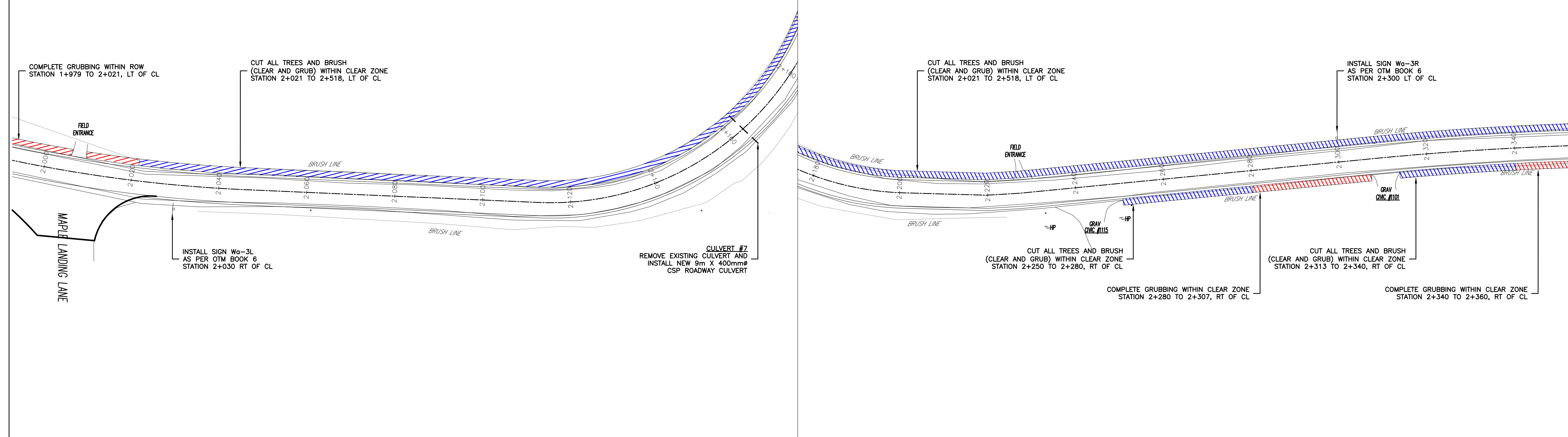
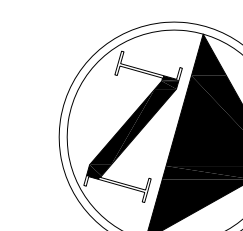
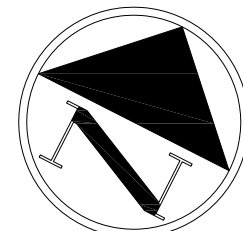

STEENBURG LAKE NORTH ROAD

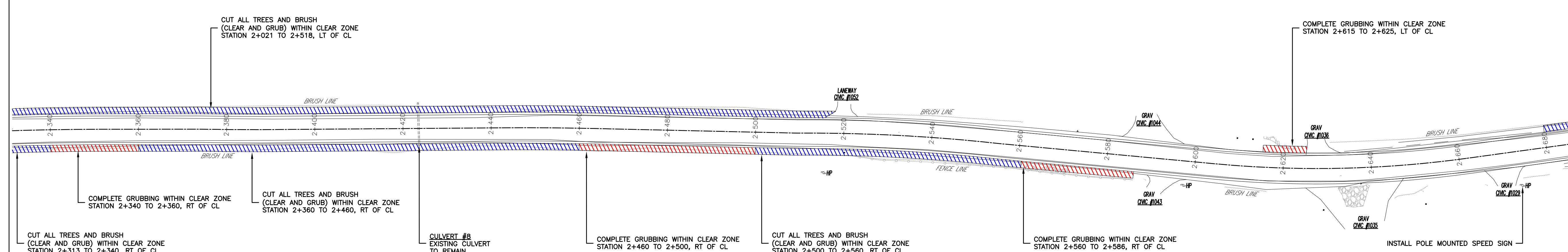
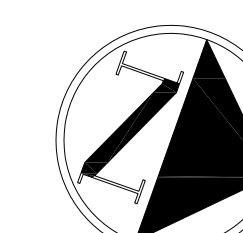

GENERAL NOTES:
 ALL INFORMATION TO BE VERIFIED ON SITE PRIOR TO COMMENCING ANY WORK. ANY DISCREPANCIES ARE TO BE REPORTED TO THE CONSULTANT IMMEDIATELY.
 ALL UTILITY LOCATIONS SHOWN ON THE DRAWINGS ARE APPROXIMATE. THE CONTRACTOR SHALL CONFIRM THE LOCATION ON SITE AND ASSUME ALL LIABILITY FOR DAMAGE TO ALL UTILITIES.
 EXCEPT THE REMOVAL AND RECEPTION PROVIDED FOR THIS PROJECT, NO OTHER ELEVATIONS ARE TO BE USED AS A REFERENCE ELEVATION FOR ANY PURPOSES.
METRIC NOTE:
 ALL DIMENSIONS SHOWN ARE IN METRES OR MILLIMETRES UNLESS OTHERWISE NOTED.
**** DRAWINGS ARE NOT TO BE SCALED ****

REVISIONS			
No.	Date	Description	By
0	12/13/2016	PRELIMINARY DRAWINGS FOR REVIEW	CB
1	03/24/2017	FINAL DESIGN FOR CLIENT REVIEW	CB

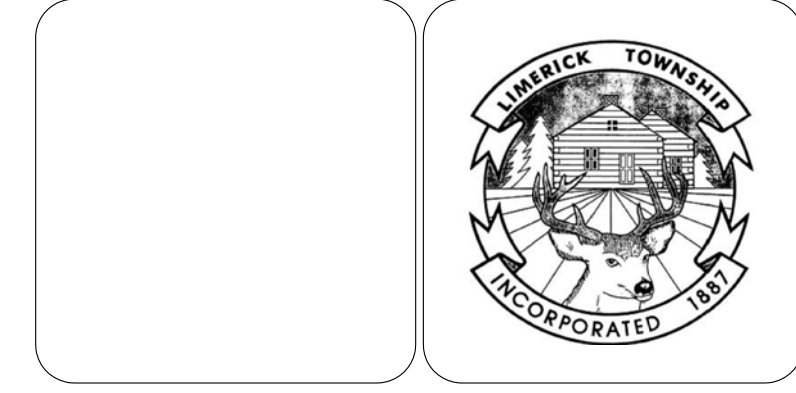

G.D. JEWELL ENGINEERING INC.
 CONSULTING ENGINEERS

HINGSTON **BELLEVEILLE** **MISSISSAUGA**

TEL: (913) 386-7250 TEL: (913) 966-1111 TEL: (905) 855-1552
 FAX: (913) 386-2754 FAX: (913) 969-6986 FAX: (905) 855-5428
 Email: hgingston@jewelleng.ca Email: hlingwell@jewelleng.ca Email: hmississauga@jewelleng.ca

TOLL FREE 1-800-966-4338
 www.jewelleng.ca

**TOWNSHIP OF LIMERICK
 REHABILITATION
 STEENBURG LAKE ROAD NORTH**

Drawn by:	Project No:	
CCG	150-3794	
Designed by:	Date:	
CB	MARCH 2016	
Checked by:	Scale - Hor: 1:500	
CB	Vert:	
Approved by:	Contract No:	Drawing No:
CB		4

STEENBURG LAKE NORTH ROAD

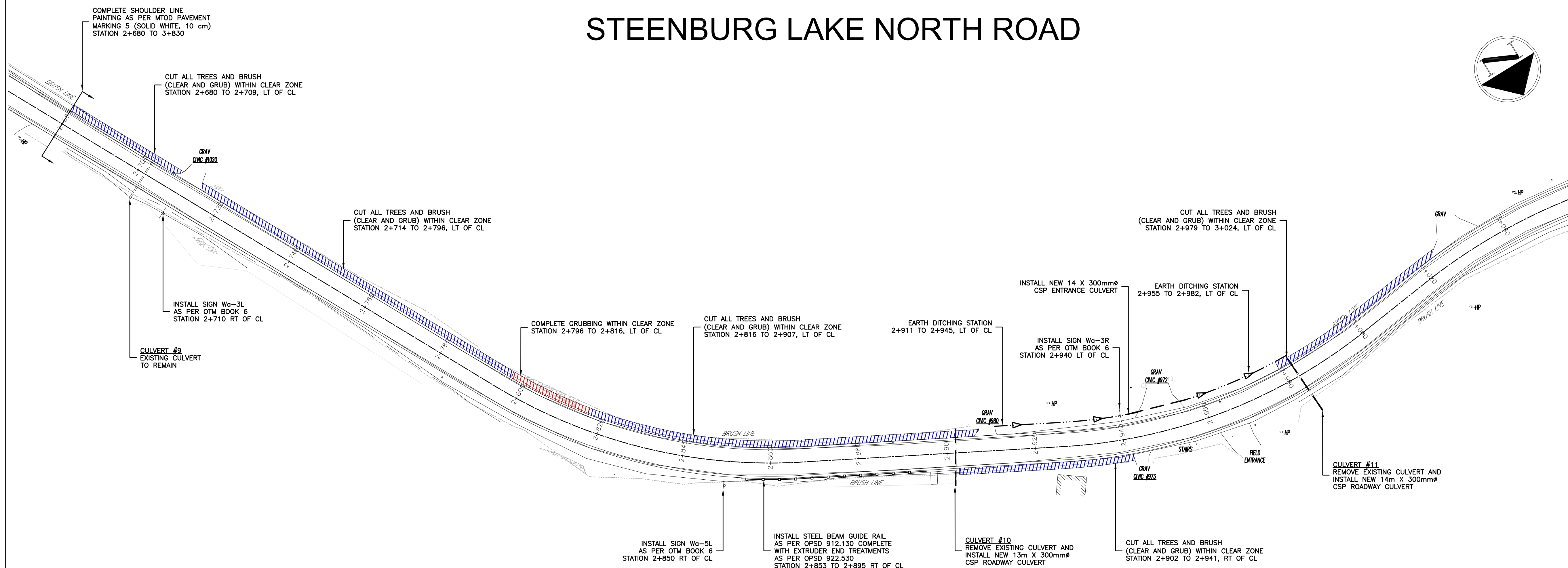

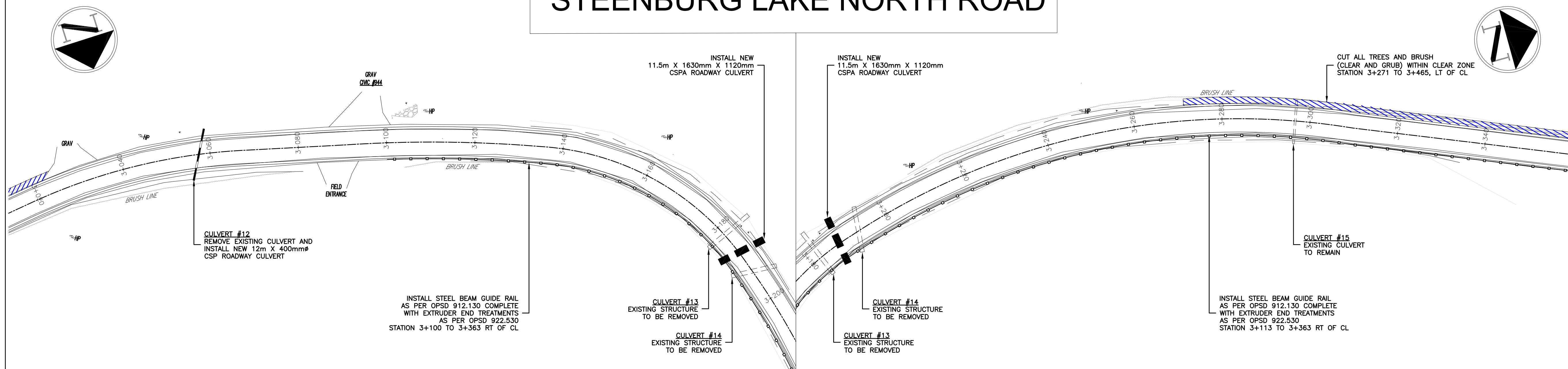

STEENBURG LAKE NORTH ROAD



GENERAL NOTES:
 ALL INFORMATION TO BE VERIFIED ON SITE PRIOR TO COMMENCING ANY WORK. ANY DISCREPANCIES ARE TO BE REPORTED TO THE CONSULTANT IMMEDIATELY.
 ALL UTILITY LOCATIONS SHOWN ON THE DRAWINGS ARE APPROXIMATE. THE CONTRACTOR SHALL CONFIRM THE LOCATION ON SITE AND ASSUME ALL LIABILITY FOR DAMAGE TO ALL UTILITIES.
 EXCLUDING THE REMOVAL AND RECEPTION PROVIDED FOR THIS PROJECT, NO OTHER ELEVATIONS ARE TO BE USED AS A REFERENCE ELEVATION FOR ANY PURPOSES.
METRIC NOTE:
 ALL DIMENSIONS SHOWN ARE IN METRES OR MILLIMETRES UNLESS OTHERWISE NOTED.
**** DRAWINGS ARE NOT TO BE SCALED ****

REVISIONS			
No.	Date	Description	By
0	12/13/2016	PRELIMINARY DRAWINGS FOR REVIEW	CB
1	03/24/2017	FINAL DESIGN FOR CLIENT REVIEW	CB





G.D. JEWELL ENGINEERING INC.
CONSULTING ENGINEERS

HINGSTON TEL: (813) 386-7250 FAX: (813) 386-2754 Email: hgingston@jewelleng.ca	BELLEVILLE TEL: (813) 966-1111 FAX: (813) 966-6986 Email: hking@jewelleng.ca	MISSISSAUGA TEL: (905) 856-1592 FAX: (905) 856-5428 Email: hking@jewelleng.ca
---	---	--

TOLL FREE 1-800-966-4338
www.jewelleng.ca

**TOWNSHIP OF LIMERICK
 REHABILITATION
 STEENBURG LAKE ROAD NORTH**

Drawn by:	Project No:	
CCG	150-3794	
Designed by:	Date:	
CB	MARCH 2016	
Checked by:	Scale - Hor: 1:500	
CB	Vert:	
Approved by:	Contract No:	Drawing No:
CB		5

STEENBURG LAKE NORTH ROAD

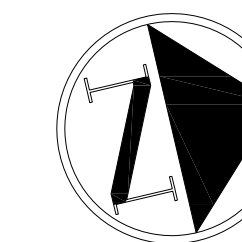

GENERAL NOTES:
 ALL INFORMATION TO BE VERIFIED ON SITE PRIOR TO COMMENCING ANY WORK. ANY DISCREPANCIES ARE TO BE REPORTED TO THE CONSULTING ENGINEER.
 ALL ELEVATIONS SHOWN ON THE DRAWINGS ARE APPROXIMATE. THE CONTRACTOR SHALL CONFIRM THE LOCATION ON SITE AND ASSUME ALL LIABILITY FOR DAMAGE TO ALL UTILITIES.
 EXCLUDING THE REMOVAL AND RECEPTION PROVIDED FOR THIS PROJECT, NO OTHER ELEVATIONS ARE TO BE USED AS A REFERENCE ELEVATION FOR ANY PURPOSES.
METRIC NOTE:
 ALL DIMENSIONS SHOWN ARE IN METRES OR MILLIMETRES UNLESS OTHERWISE NOTED.
**** DRAWINGS ARE NOT TO BE SCALED ****

REVISIONS			
No.	Date	Description	By
0	12/13/2016	PRELIMINARY DRAWINGS FOR REVIEW	CB
1	03/24/2017	FINAL DESIGN FOR CLIENT REVIEW	CB

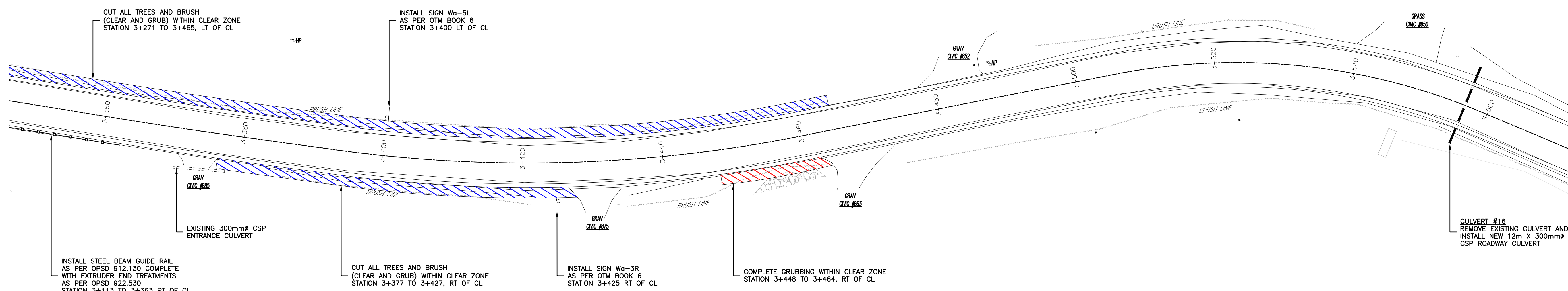

GENERAL CONSTRUCTION NOTE:
 TWO PRIVATE ACTIVE WATERLINES LOCATED THROUGH CULVERT 16. CONTRACTOR IS TO NOTIFY HOMEOWNERS PRIOR TO CULVERT REPLACEMENT TO MINIMIZE SERVICE DISRUPTION.

STEENBURG LAKE NORTH ROAD

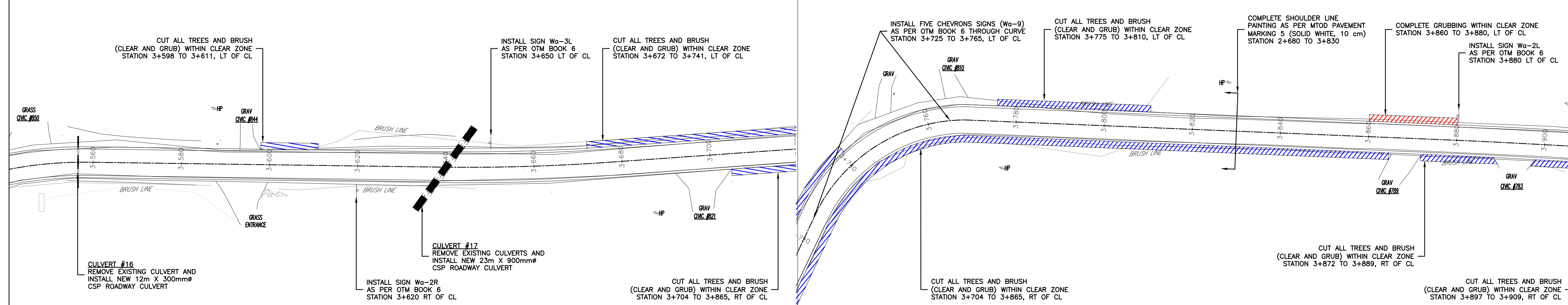
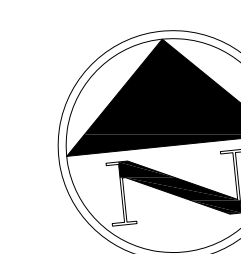
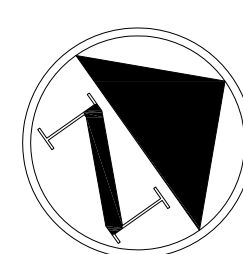

G.D. JEWELL ENGINEERING INC.
 CONSULTING ENGINEERS

HINGSTON TEL: (813) 386-7250 FAX: (813) 386-2754 Email: gdj@jewelleng.ca	BELLEVILLE TEL: (813) 966-1111 FAX: (813) 966-6986 Email: hrd@jewelleng.ca	MISSISSAUGA TEL: (905) 856-1592 FAX: (905) 856-5428 Email: hrd@jewelleng.ca
---	---	--

TOLL FREE 1-800-966-4338
 www.jewelleng.ca

**TOWNSHIP OF LIMERICK
 REHABILITATION
 STEENBURG LAKE ROAD NORTH**

Drawn by: CCG Project No: 150-3794
 Date: MARCH 2016
 Checked by: CB Scale - Hor: 1:500
 Vert:
 Approved by: CB Contract No: Drawing No: 6

STEENBURG LAKE NORTH ROAD

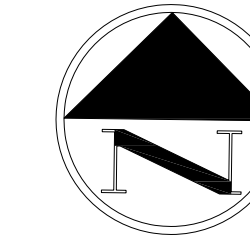

GENERAL NOTES:
 ALL INFORMATION TO BE VERIFIED ON SITE PRIOR TO COMMENCING ANY WORK. ANY DISCREPANCIES ARE TO BE REPORTED TO THE CONSULTING ENGINEER.
 ALL ELEVATION LOCATIONS SHOWN ON THE DRAWINGS ARE APPROXIMATE. THE CONTRACTOR SHALL CONFIRM THE LOCATION ON SITE AND ASSUME ALL LIABILITY FOR DAMAGE TO ALL UTILITIES.
 EXCEPTING THE REMARKS AND DESCRIPTION PROVIDED FOR THIS PROJECT, NO OTHER ELEVATIONS ARE TO BE USED AS A REFERENCE ELEVATION FOR ANY PURPOSES.
METRIC NOTE:
 ALL DIMENSIONS SHOWN ARE IN METRES OR MILLIMETRES UNLESS OTHERWISE NOTED.
**** DRAWINGS ARE NOT TO BE SCALED ****

REVISIONS			
No.	Date	Description	By
0	12/13/2016	PRELIMINARY DRAWINGS FOR REVIEW	CB
1	03/24/2017	FINAL DESIGN FOR CLIENT REVIEW	CB

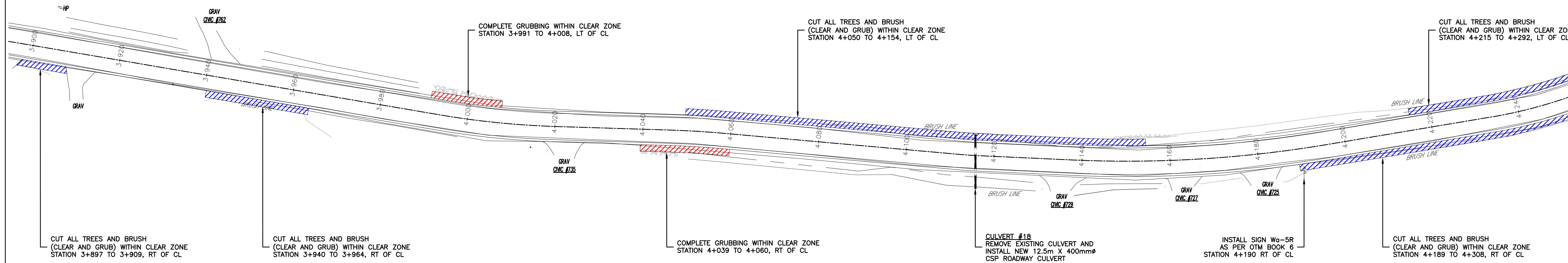

STEENBURG LAKE NORTH ROAD

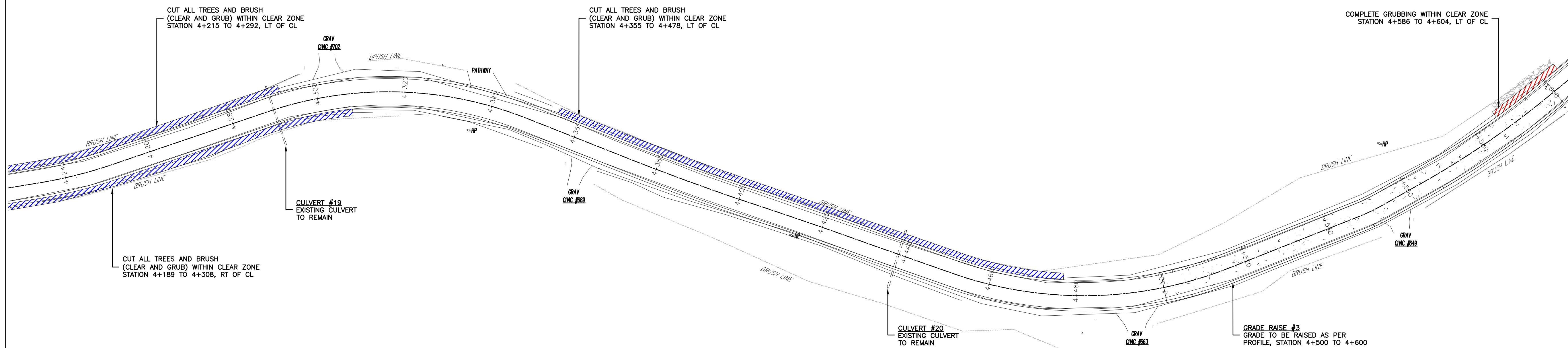
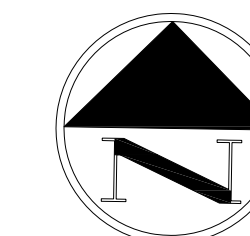

G.D. JEWELL ENGINEERING INC.
 CONSULTING ENGINEERS

HINGSTON TEL: (613) 386-7250 FAX: (613) 386-2754 Email: hgingston@jewelleng.ca	BELLEVEILLE TEL: (613) 966-1111 FAX: (613) 969-6986 Email: hbell@jewelleng.ca	MISSISSAUGA TEL: (905) 855-1552 FAX: (905) 855-5428 Email: hmiss@jewelleng.ca
--	---	---

TOLL FREE 1-800-966-4338
 www.jewelleng.ca

**TOWNSHIP OF LIMERICK
 REHABILITATION
 STEENBURG LAKE ROAD NORTH**

Drawn by: CCG	Project No: 150-3794
Designed by: CB	Date: MARCH 2016
Checked by: CB	Scale - Hor: 1:500 Vert:
Approved by: CB	Contract No: Drawing No: 7

STEENBURG LAKE NORTH ROAD

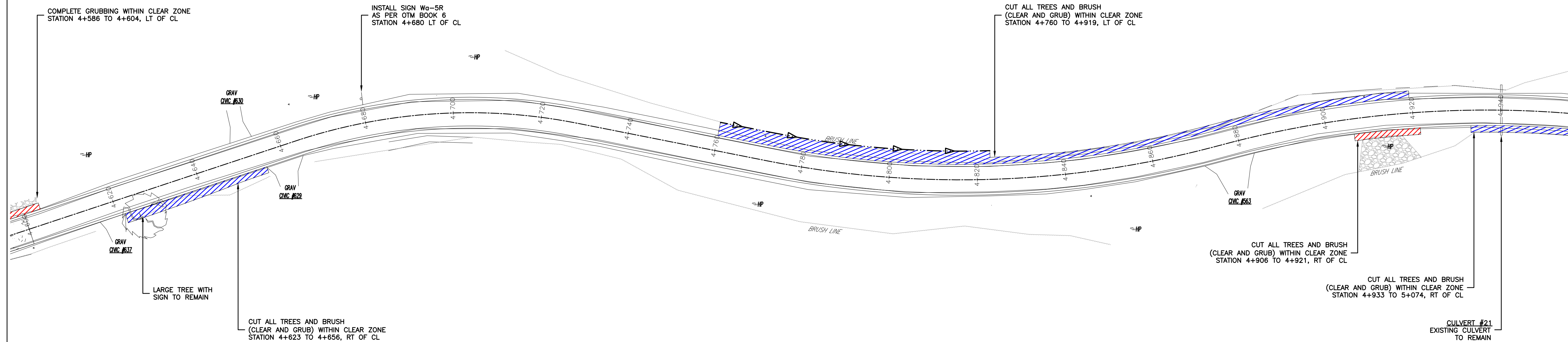
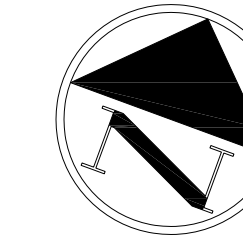

GENERAL NOTES:
 ALL INFORMATION TO BE VERIFIED ON SITE PRIOR TO COMMENCING ANY WORK. ANY DISCREPANCIES ARE TO BE REPORTED TO THE CONSULTING ENGINEER.
 ALL UTILITY LOCATIONS SHOWN ON THE DRAWINGS ARE APPROXIMATE. THE CONTRACTOR SHALL CONFIRM THE LOCATION ON SITE AND ASSUME ALL LIABILITY FOR DAMAGE TO ALL UTILITIES.
 EXCEPTING THE REMOVAL AND RECONSTRUCTION PROVIDED FOR THIS PROJECT, NO OTHER ELEVATIONS ARE TO BE USED AS A REFERENCE ELEVATION FOR ANY PURPOSES.
METRIC NOTE:
 ALL DIMENSIONS SHOWN ARE IN METRES OR MILLIMETRES UNLESS OTHERWISE NOTED.
**** DRAWINGS ARE NOT TO BE SCALED ****

REVISIONS			
No.	Date	Description	By
0	12/13/2016	PRELIMINARY DRAWINGS FOR REVIEW	CB
1	03/24/2017	FINAL DESIGN FOR CLIENT REVIEW	CB

STEENBURG LAKE NORTH ROAD

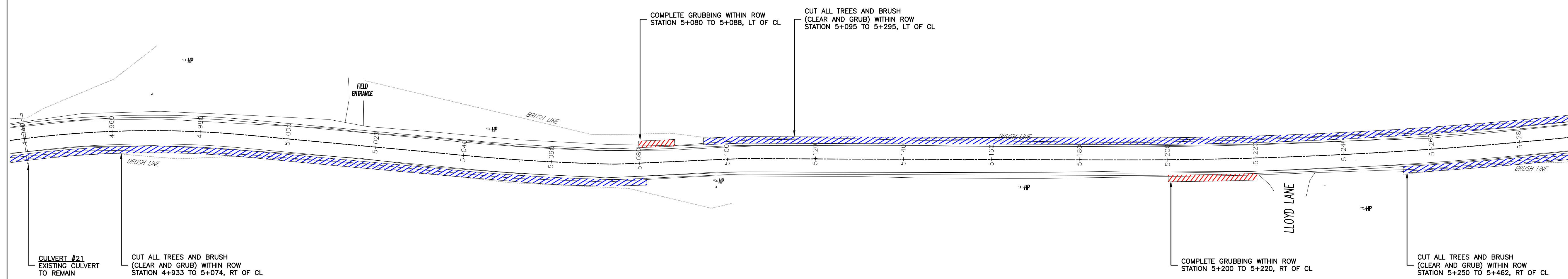
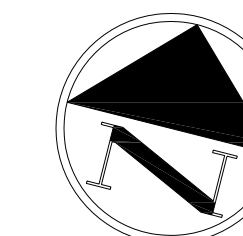

G.D. JEWELL ENGINEERING INC.
 CONSULTING ENGINEERS

HINGSTON **BELLEVILLE** **MISSISSAUGA**

TEL: (913) 386-7250 TEL: (913) 966-1111 TEL: (905) 855-1502
 FAX: (913) 386-2754 FAX: (913) 969-6985 FAX: (905) 855-5428
 Email: hgingston@jewelleng.ca Email: hlingwell@jewelleng.ca Email: hkingston@jewelleng.ca

TOLL FREE 1-800-966-4338
 www.jewelleng.ca

**TOWNSHIP OF LIMERICK
 REHABILITATION
 STEENBURG LAKE ROAD NORTH**

Drawn by:	Project No:	
CCG	150-3794	
Designed by:	Date:	
CB	MARCH 2016	
Checked by:	Scale - Hor: 1:500	
CB	Vert:	
Approved by:	Contract No:	Drawing No:
CB		8

STEENBURG LAKE NORTH ROAD

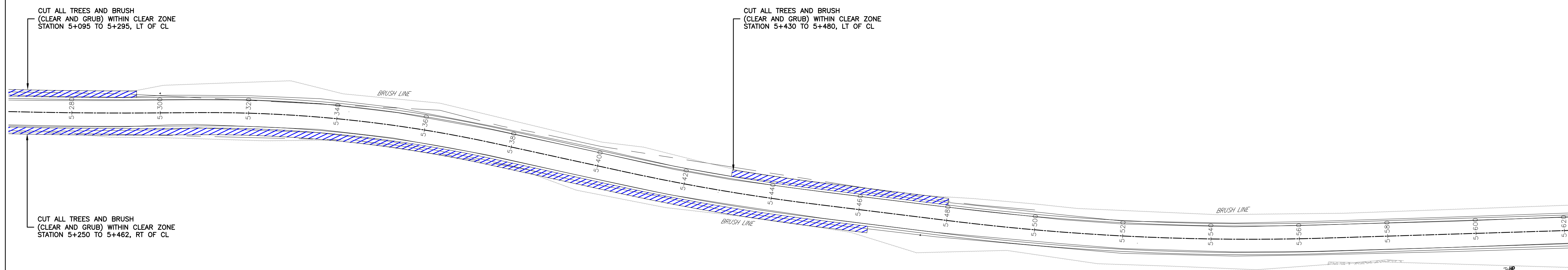
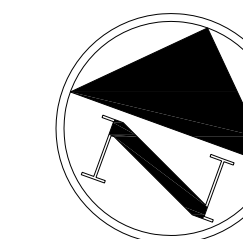

GENERAL NOTES:
 ALL INFORMATION TO BE VERIFIED ON SITE PRIOR TO COMMENCING ANY WORK. ANY DISCREPANCIES ARE TO BE REPORTED TO THE CONSULTING ENGINEER.
 ALL UTILITY LOCATIONS SHOWN ON THE DRAWINGS ARE APPROXIMATE. THE CONTRACTOR SHALL VERIFY THE LOCATION ON SITE AND ASSUME ALL LIABILITY FOR DAMAGE TO ALL UTILITIES.
 EXCEPTING THE REMOVAL AND RECEPTION PROVIDED FOR THIS PROJECT, NO OTHER ELEVATIONS ARE TO BE USED AS A REFERENCE ELEVATION FOR ANY PURPOSES.
METRIC NOTE:
 ALL DIMENSIONS SHOWN ARE IN METRES OR MILLIMETRES UNLESS OTHERWISE NOTED.
**** DRAWINGS ARE NOT TO BE SCALED ****

REVISIONS			
No.	Date	Description	By
0	12/13/2016	PRELIMINARY DRAWINGS FOR REVIEW	CB
1	03/24/2017	FINAL DESIGN FOR CLIENT REVIEW	CB

STEENBURG LAKE NORTH ROAD

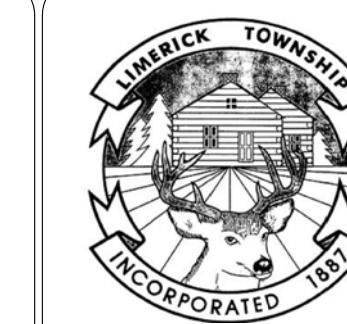
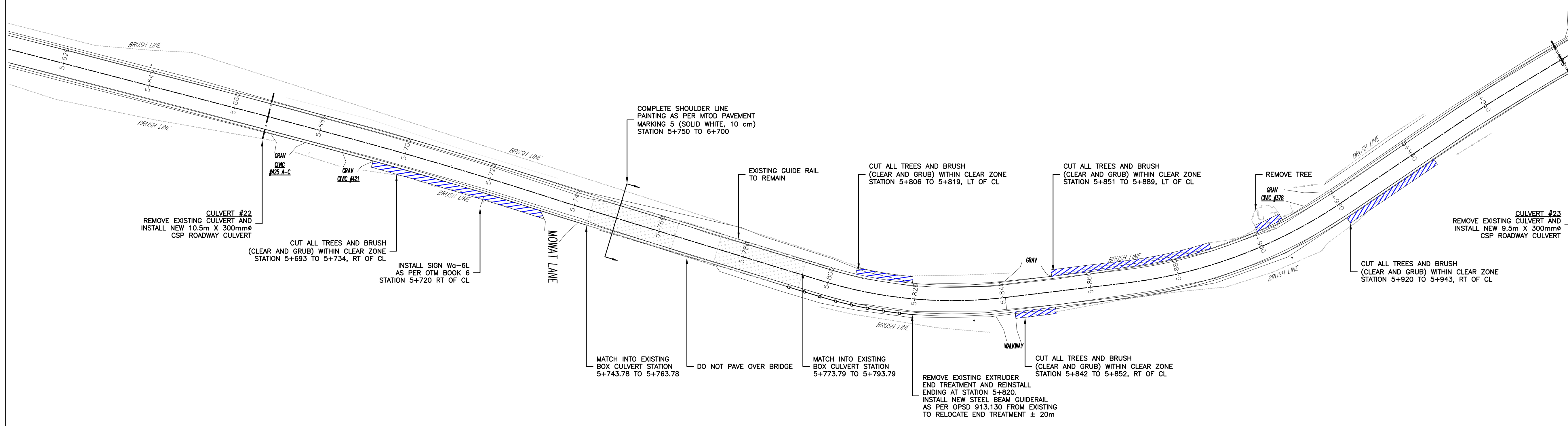
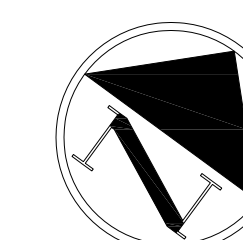

G.D. JEWELL ENGINEERING INC.
 CONSULTING ENGINEERS

KINGSTON: TEL: (613) 396-7250 FAX: (613) 396-2754 Email: gajewell@jewelleng.ca
 BELLEVILLE: TEL: (613) 968-1111 FAX: (613) 968-6986 Email: hjewell@jewelleng.ca
 MISSISSAUGA: TEL: (905) 855-1502 FAX: (905) 855-5428 Email: hjewell@jewelleng.ca

TOLL FREE 1-800-966-4338
 www.jewelleng.ca

**TOWNSHIP OF LIMERICK
 REHABILITATION
 STEENBURG LAKE ROAD NORTH**

Drawn by: CCG Project No: 150-3794
 Designed by: CB Date: MARCH 2016
 Checked by: CB Scale - Hor: 1:500 Vert:
 Approved by: CB Contract No: Drawing No: 9

STEENBURG LAKE NORTH ROAD

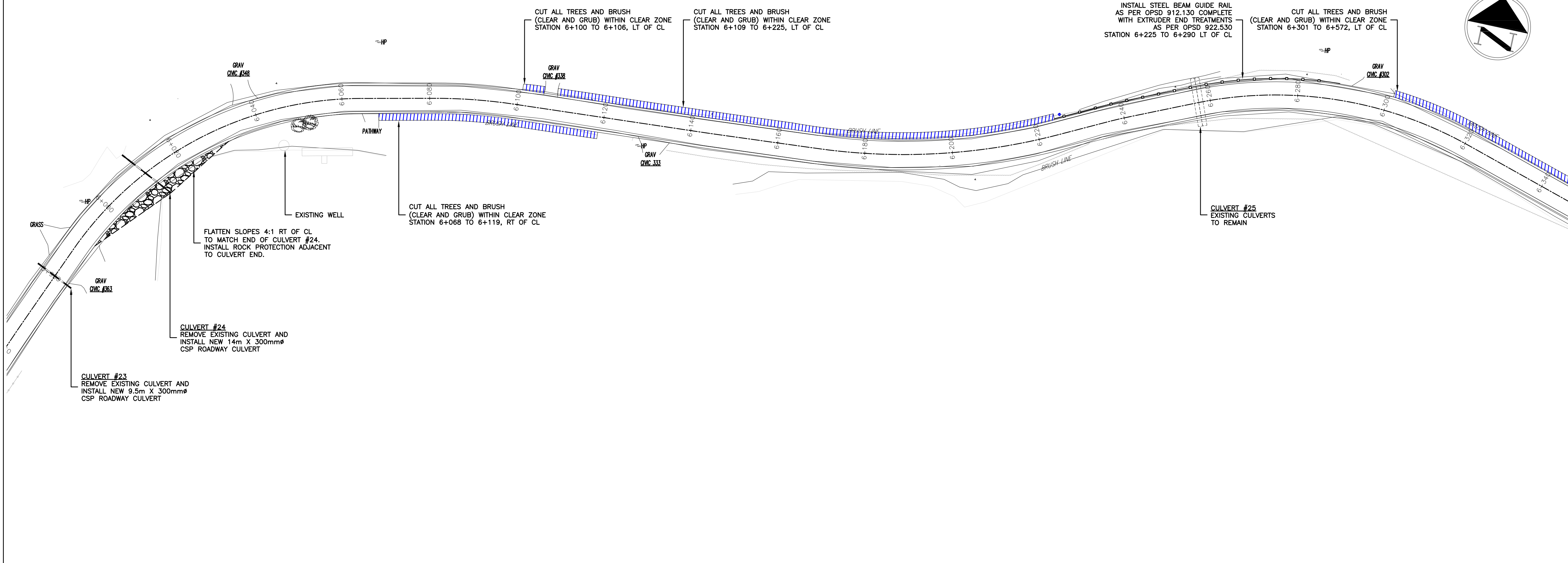

GENERAL NOTES:
 ALL INFORMATION TO BE NOTED ON SITE PRIOR TO COMMENCING ANY WORK. ANY DISCREPANCIES ARE TO BE REPORTED TO THE CONSULTING ENGINEER.
 ALL UTILITY LOCATIONS SHOWN ON THE DRAWINGS ARE APPROXIMATE. THE CONTRACTOR SHALL CONFIRM THE LOCATION OF SITE AND ASSUME ALL LIABILITY FOR DAMAGE TO ALL UTILITIES.
 EXCLUDING THE BENCHMARK AND OCCUPATION PROVIDED FOR THIS PROJECT, NO OTHER ELEVATIONS ARE TO BE USED AS A REFERENCE ELEVATION OR ANY PURPOSE.
METRIC NOTE:
 ALL DIMENSIONS SHOWN ARE IN METERS OR MILLIMETERS UNLESS OTHERWISE NOTED.
**** DRAWINGS ARE NOT TO BE SCALED ****

REVISIONS			
No.	Date	Description	By
0	12/15/2016	PRELIMINARY DRAWINGS FOR REVIEW	CB
1	03/24/2017	FINAL DESIGN FOR CLIENT REVIEW	CB

STEENBURG LAKE NORTH ROAD

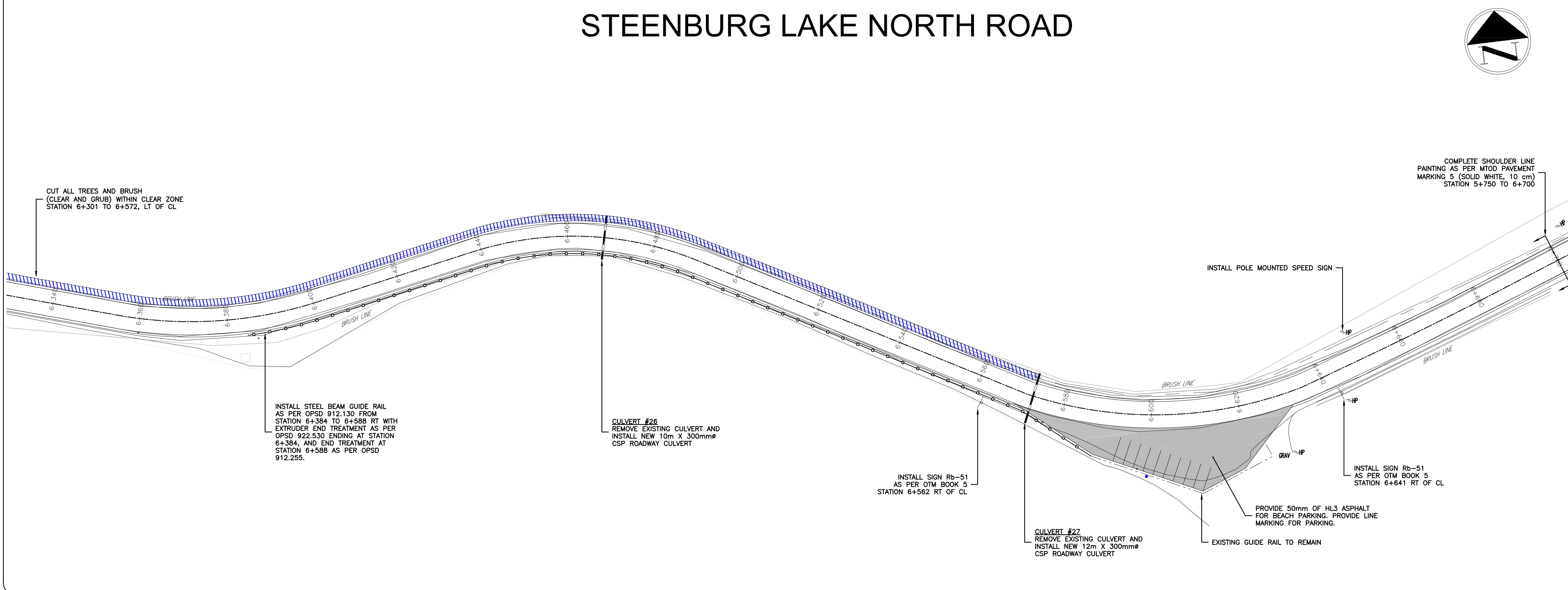



TOWNSHIP OF LIMERICK
 REHABILITATION
 STEENBURG LAKE ROAD NORTH

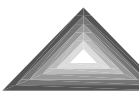

G.D. JEWELL ENGINEERING INC.
 CONSULTING ENGINEERS

KINGSTON TEL: (613) 389-7250 FAX: (613) 389-2354 Email: kjewell@gdjewell.com	BELLEVILLE TEL: (613) 969-1111 FAX: (613) 969-8988 Email: kjewell@gdjewell.com	MISSISSAUGA TEL: (905) 855-1592 FAX: (905) 855-9428 Email: mjewell@gdjewell.com
--	--	---

TOLL FREE 1-800-966-4338
www.jewelleng.ca

Drawn by: CCG
 Project No: 150-3794
 Designed by: CB
 Date: MARCH 2016
 Checked by: CB
 Scale - Hor: 1:500
 Vert:
 Approved by: CB
 Contract No:
 Drawing No: 10

STEENBURG LAKE NORTH ROAD

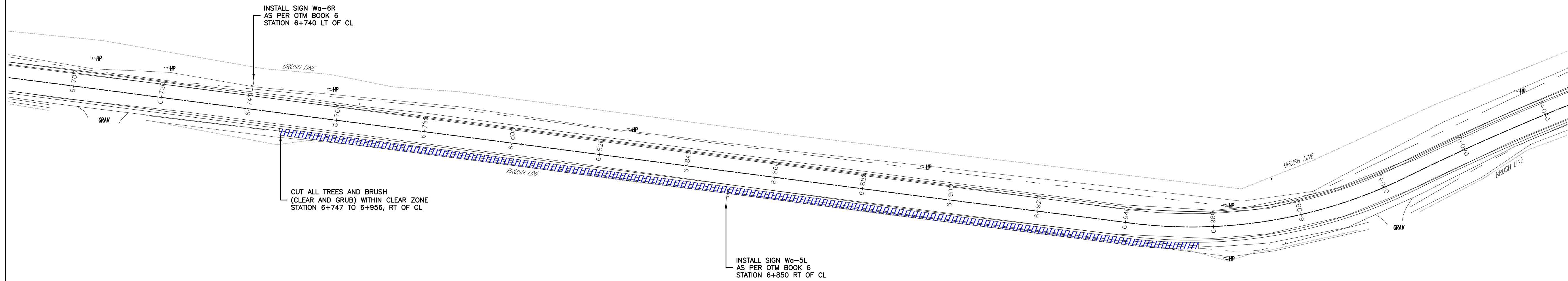
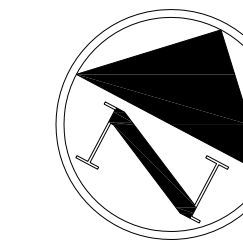

STEENBURG LAKE NORTH ROAD

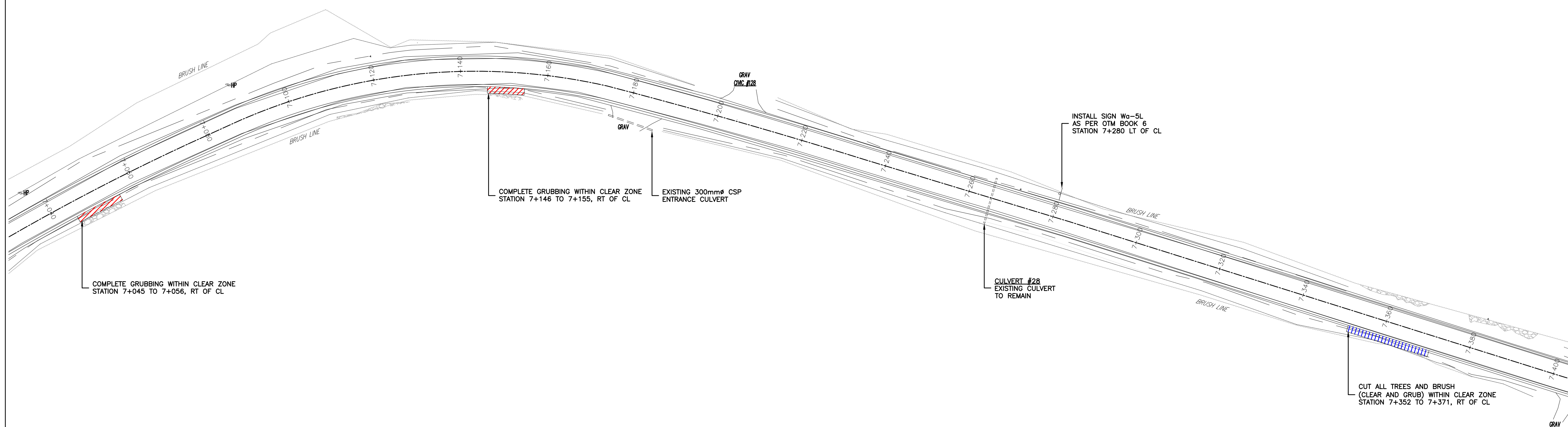
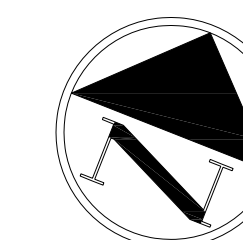

GENERAL NOTES:
 ALL INFORMATION TO BE VERIFIED ON SITE PRIOR TO COMMENCING ANY WORK. ANY DISCREPANCIES ARE TO BE REPORTED TO THE CONSULTING ENGINEER.
 ALL ELEVATIONS SHOWN ON THE DRAWINGS ARE APPROXIMATE. THE CONTRACTOR SHALL CONFIRM THE LOCATION ON SITE AND ASSUME ALL LIABILITY FOR DAMAGE TO ALL UTILITIES.
 EXCEPT THE REMOVAL AND RECONSTRUCTION PROVIDED FOR THIS PROJECT, NO OTHER ELEVATIONS ARE TO BE USED AS A REFERENCE ELEVATION FOR ANY PURPOSES.
METRIC NOTE:
 ALL DIMENSIONS SHOWN ARE IN METRES OR MILLIMETRES UNLESS OTHERWISE NOTED.
**** DRAWINGS ARE NOT TO BE SCALED ****

REVISIONS			
No.	Date	Description	By
0	12/13/2016	PRELIMINARY DRAWINGS FOR REVIEW	CB
1	03/24/2017	FINAL DESIGN FOR CLIENT REVIEW	CB



G.D. JEWELL ENGINEERING INC.
 CONSULTING ENGINEERS

WINGSTON TEL: (813) 386-7250 FAX: (813) 386-2754 Email: gdw@jewelleng.ca	BELLEVILLE TEL: (813) 966-1111 FAX: (813) 966-4986 Email: hld@jewelleng.ca	MISSISSAUGA TEL: (905) 856-1502 FAX: (905) 856-5428 Email: hld@jewelleng.ca
--	--	---

TOLL FREE 1-800-966-4338
 www.jewelleng.ca

TOWNSHIP OF LIMERICK
 REHABILITATION
 STEENBURG LAKE ROAD NORTH

Drawn by: CCG
 Project No: 150-3794

Designed by: CB
 Date: MARCH 2016

Checked by: CB
 Scale - Hor: 1:500
 Vert:

Approved by: CB
 Contract No:
 Drawing No: 11

STEENBURG LAKE NORTH ROAD

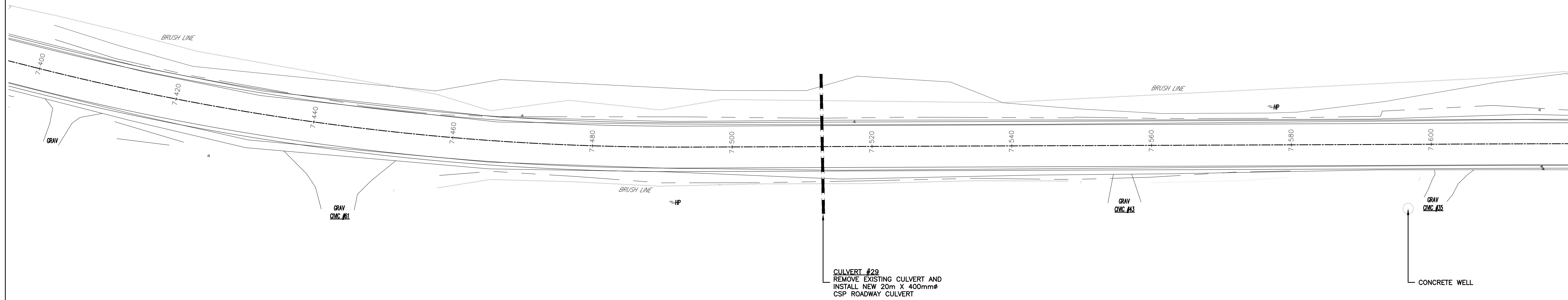
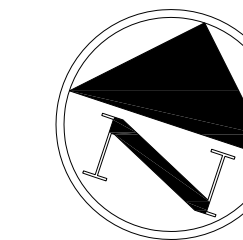

GENERAL NOTES:
 ALL INFORMATION TO BE VERIFIED ON SITE PRIOR TO COMMENCING ANY WORK. ANY DISCREPANCIES ARE TO BE REPORTED TO THE CONSULTING ENGINEER.
 ALL ELEVATIONS SHOWN ON THE DRAWINGS ARE APPROXIMATE. THE CONTRACTOR SHALL CONFIRM THE LOCATION ON SITE AND ASSUME ALL LIABILITY FOR DAMAGE TO ALL UTILITIES.
 EXCLUDING THE REMOVAL AND RECEPTION PROVIDED FOR THIS PROJECT, NO OTHER ELEVATIONS ARE TO BE USED AS A REFERENCE ELEVATION FOR ANY PURPOSES.

METRIC NOTE:
 ALL DIMENSIONS SHOWN ARE IN METRES OR MILLIMETRES UNLESS OTHERWISE NOTED.
**** DRAWINGS ARE NOT TO BE SCALED ****

REVISIONS			
No.	Date	Description	By
0	12/13/2016	PRELIMINARY DRAWINGS FOR REVIEW	CB
1	03/24/2017	FINAL DESIGN FOR CLIENT REVIEW	CB

STEENBURG LAKE NORTH ROAD

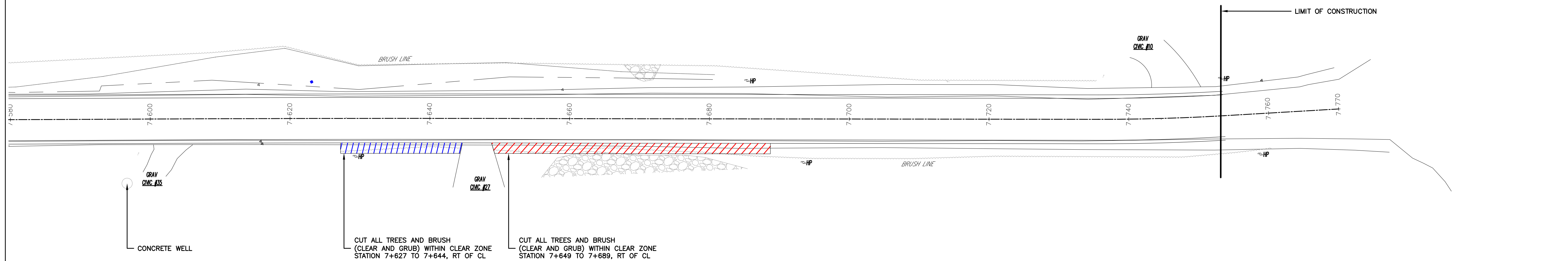
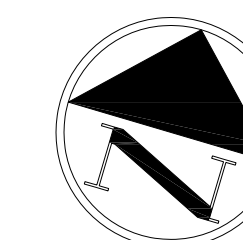

G.D. JEWELL ENGINEERING INC.
 CONSULTING ENGINEERS

Kingston TEL: (613) 396-7250 FAX: (613) 396-2754 Email: kgordon@jewelleng.ca
Belleville TEL: (613) 968-1111 FAX: (613) 968-6986 Email: hrd@jewelleng.ca
Mississauga TEL: (905) 856-1502 FAX: (905) 856-5428 Email: hrd@jewelleng.ca

TOLL FREE 1-800-966-4338
 www.jewelleng.ca

**TOWNSHIP OF LIMERICK
 REHABILITATION
 STEENBURG LAKE ROAD NORTH**

Drawn by: CCG Project No: 150-3794
 Designed by: CB Date: MARCH 2016
 Checked by: CB Scale - Hor: 1:500 Vert:
 Approved by: CB Contract No: Drawing No: 12

STEENBURG LAKE NORTH ROAD

GRADE RAISE #1

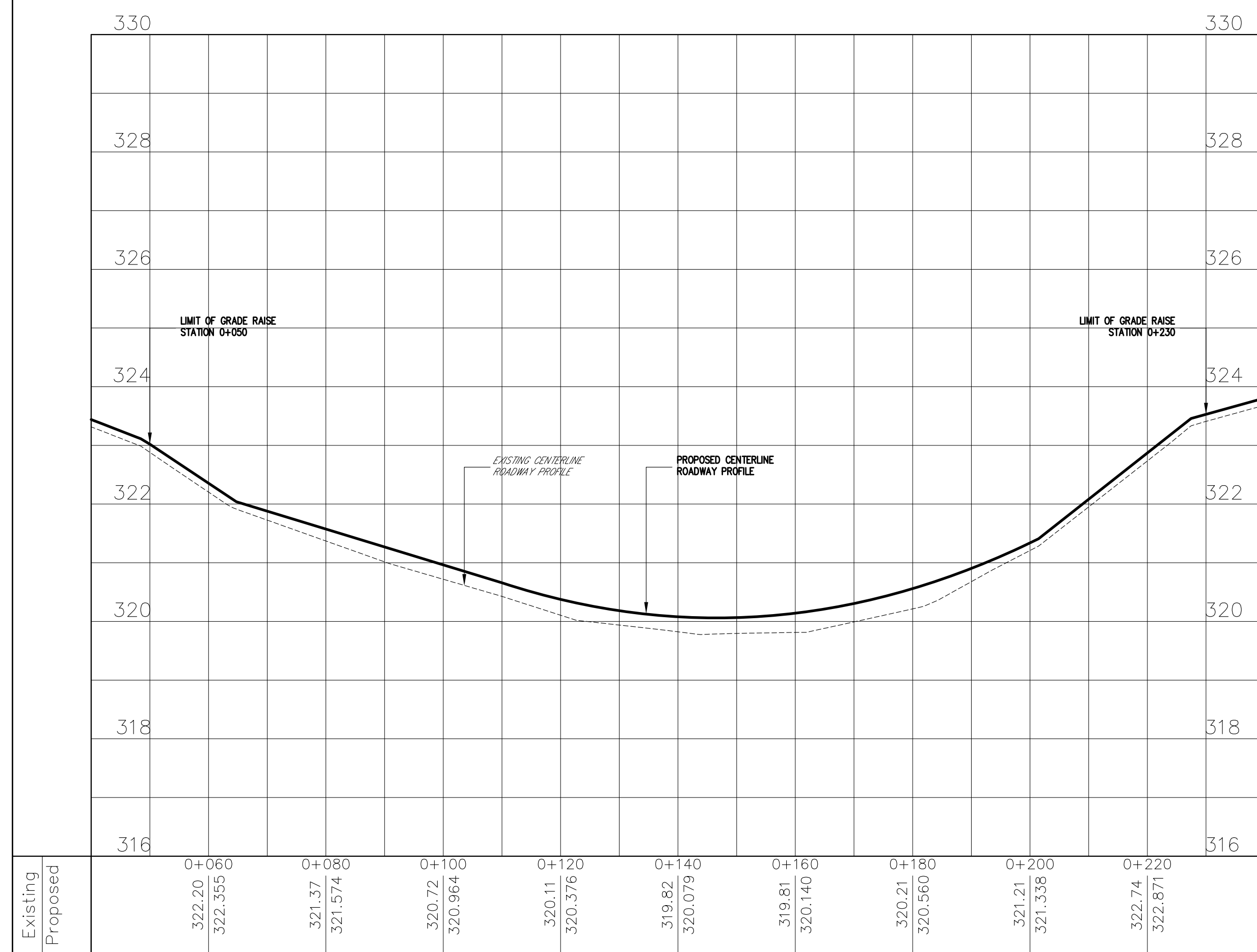

GRADE RAISE #2

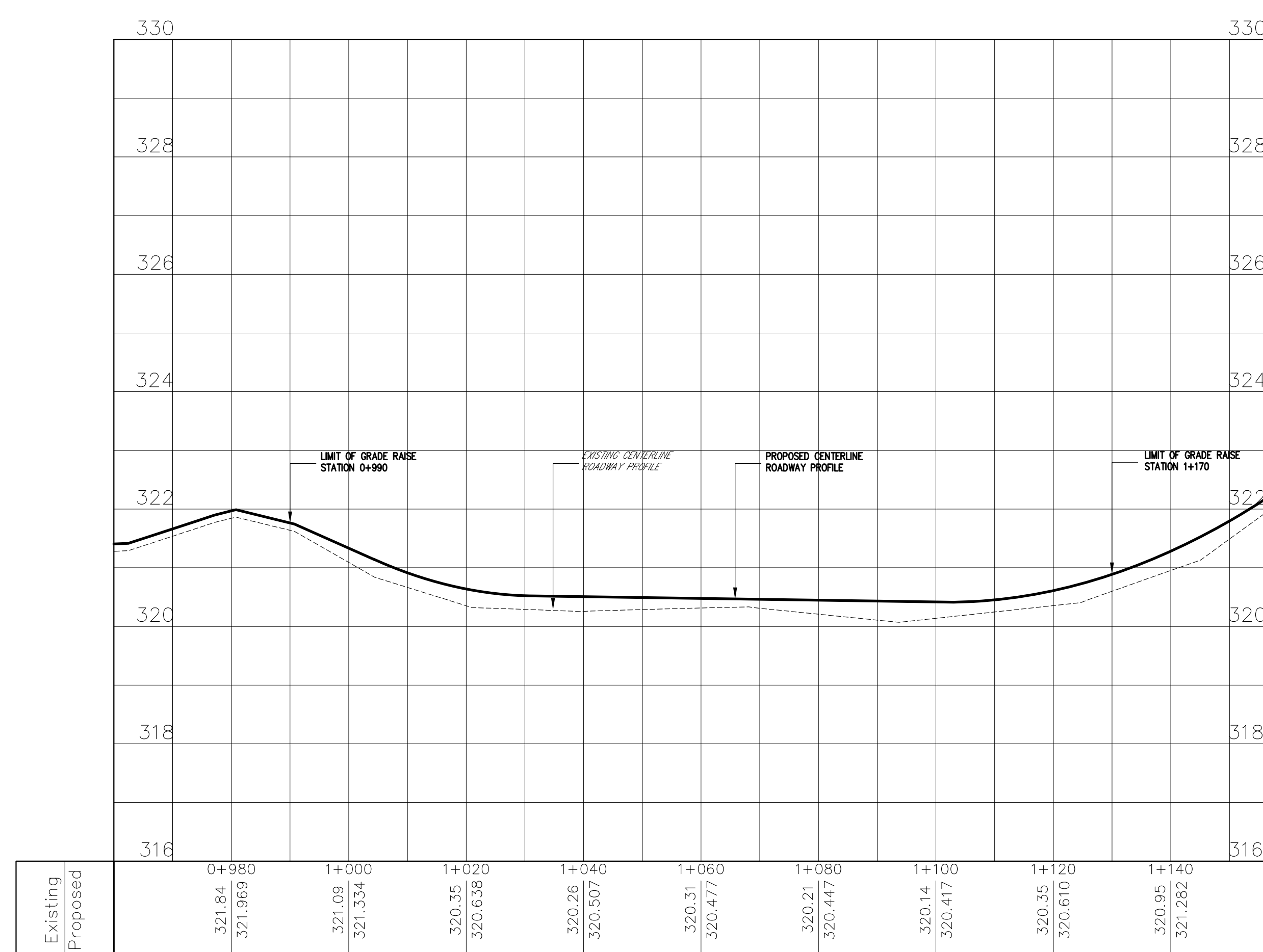

GRADE RAISE #3

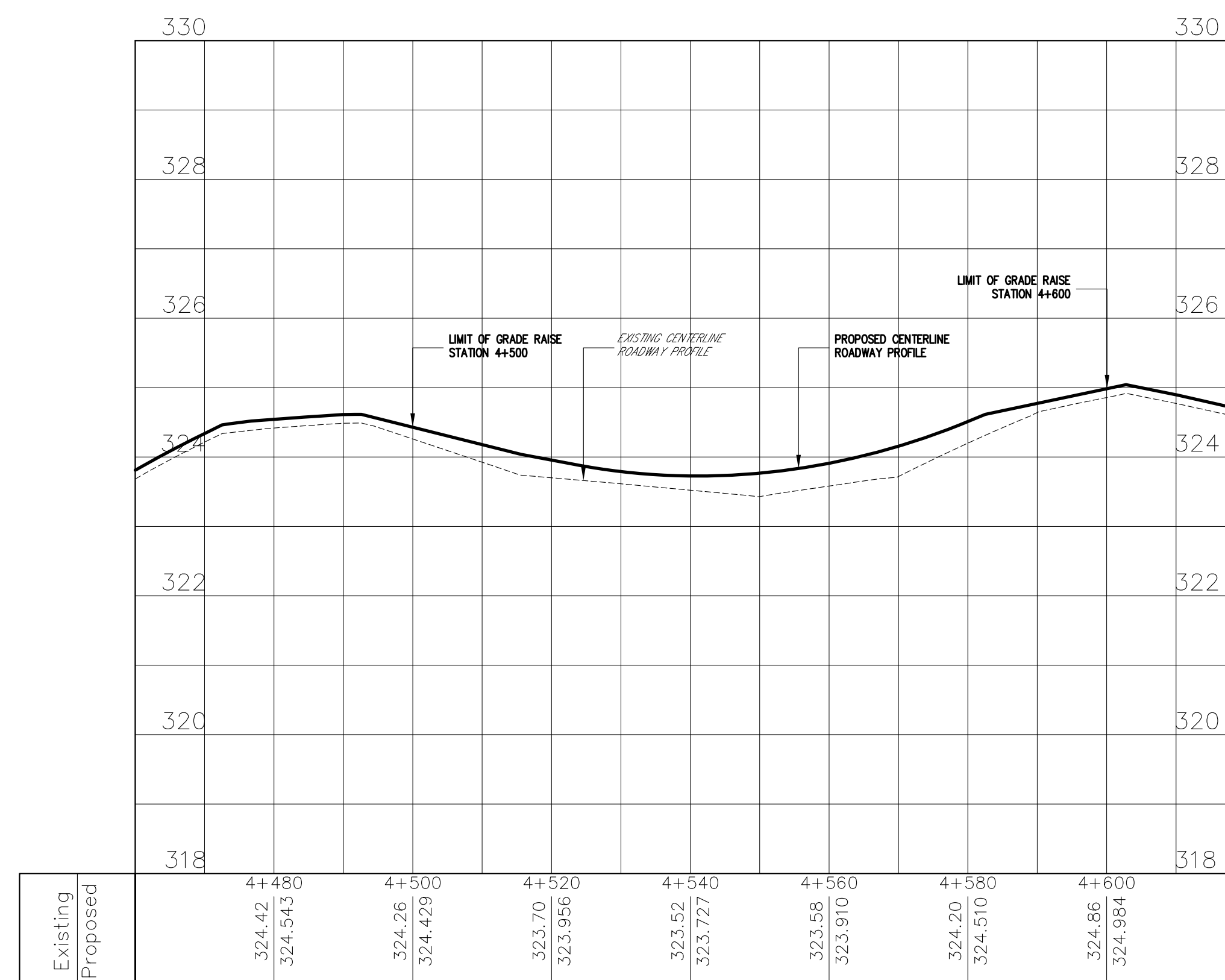

GENERAL NOTES:
 ALL INFORMATION TO BE VERIFIED ON SITE PRIOR TO COMMENCING ANY WORK. ANY DISCREPANCIES ARE TO BE REPORTED TO THE CONSULTING ENGINEER.
 ALL ELEVATIONS SHOWN ON THE DRAWINGS ARE APPROXIMATE. THE CONTRACTOR SHALL CONFIRM THE LOCATION ON SITE AND ASSUME ALL LIABILITY FOR DAMAGE TO ALL UTILITIES.
 EXCLUDING THE REMARKS AND DESCRIPTION PROVIDED FOR THIS PROJECT, NO OTHER ELEVATIONS ARE TO BE USED AS A REFERENCE ELEVATION FOR ANY PURPOSES.
METRIC NOTE:
 ALL DIMENSIONS SHOWN ARE IN METRES OR MILLIMETRES UNLESS OTHERWISE NOTED.
**** DRAWINGS ARE NOT TO BE SCALED ****

REVISIONS			
No.	Date	Description	By
0	12/13/2016	PRELIMINARY DRAWINGS FOR REVIEW	CB
1	03/24/2017	FINAL DESIGN FOR CLIENT REVIEW	CB

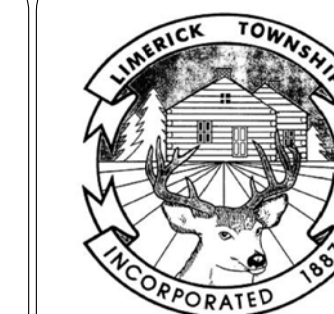

G.D. JEWELL ENGINEERING INC.
 CONSULTING ENGINEERS

KINGSTON TEL: (613) 396-7250 FAX: (613) 399-2754 Email: kgordon@jewelleng.ca	BELLEVILLE TEL: (613) 969-1111 FAX: (613) 969-6986 Email: hrd@jewelleng.ca	MISSISSAUGA TEL: (905) 855-1502 FAX: (905) 855-5428 Email: hrd@jewelleng.ca
--	--	---

TOLL FREE 1-800-966-4338
 www.jewelleng.ca

TOWNSHIP OF LIMERICK
 REHABILITATION
 STEENBURG LAKE ROAD NORTH

Drawn by: CCG
 Project No: 150-3794
 Designed by: CB
 Date: MARCH 2016
 Checked by: CB
 Scale - Hor: N.T.S.
 Vert: N.T.S.
 Approved by: CB
 Contract No:
 Drawing No: 13

STEENBURG LAKE NORTH ROAD

STEENBURG LAKE ROAD N – RECONSTRUCTION TYPICAL SECTION

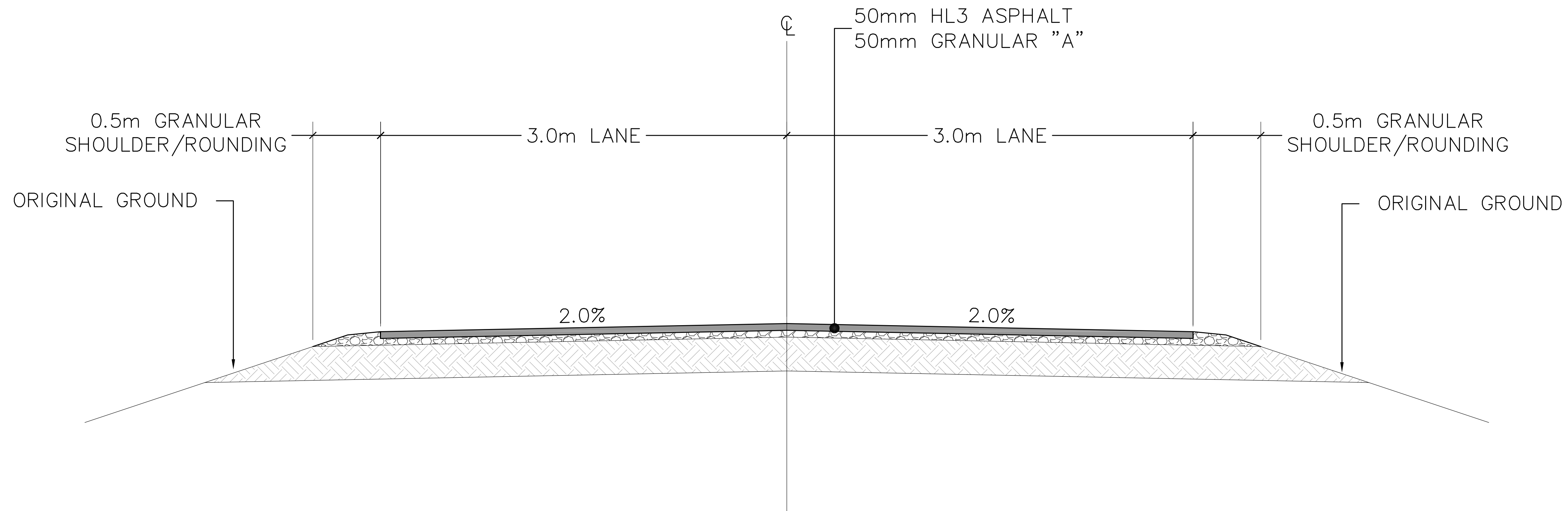

STEENBURG LAKE ROAD N – RECONSTRUCTION TYPICAL GUIDE RAIL SECTION

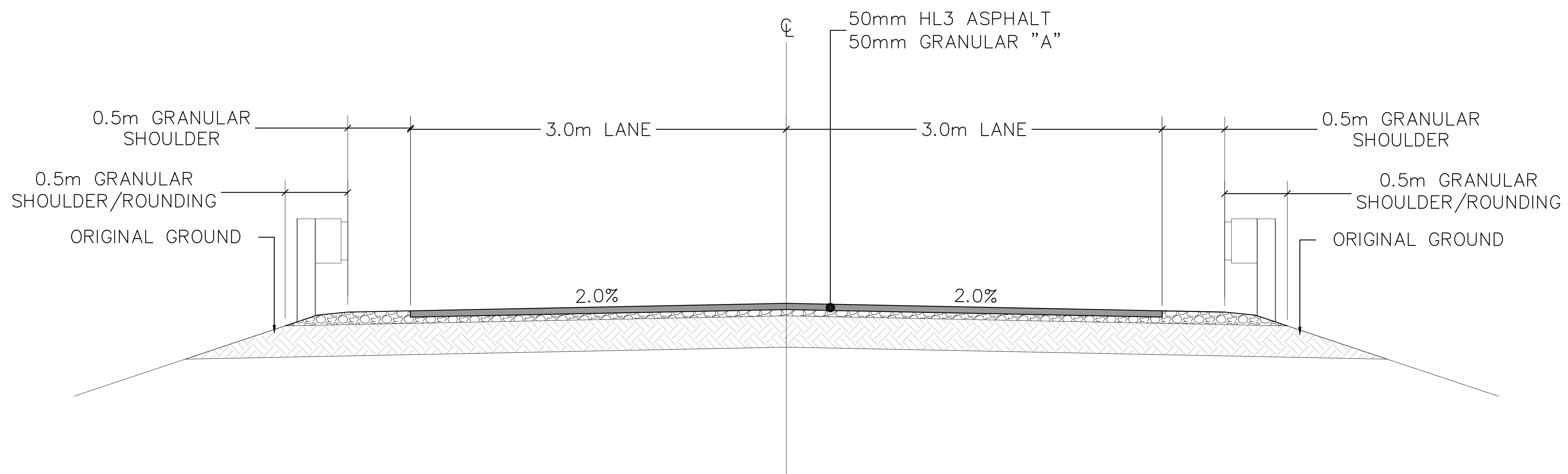

GENERAL NOTES:
 ALL INFORMATION TO BE VERIFIED ON SITE PRIOR TO COMMENCING ANY WORK. ANY DISCREPANCIES ARE TO BE REPORTED TO THE CONSULTING ENGINEER.
 ALL ELEVATIONS SHOWN ON THE DRAWINGS ARE APPROXIMATE. THE CONTRACTOR SHALL CONFIRM THE LOCATION ON SITE AND ASSUME ALL LIABILITY FOR DAMAGE TO ALL UTILITIES.
 EXCLUDING THE REMEDIATION AND RECONSTRUCTION PROVIDED FOR THIS PROJECT, NO OTHER ELEVATIONS ARE TO BE USED AS A REFERENCE ELEVATION FOR ANY PURPOSES.
METRIC NOTE:
 ALL DIMENSIONS SHOWN ARE IN METRES OR MILLIMETRES UNLESS OTHERWISE NOTED.
**** DRAWINGS ARE NOT TO BE SCALED ****

REVISIONS			
No.	Date	Description	By
0	12/13/2016	PRELIMINARY DRAWINGS FOR REVIEW	CB
1	03/24/2017	FINAL DESIGN FOR CLIENT REVIEW	CB

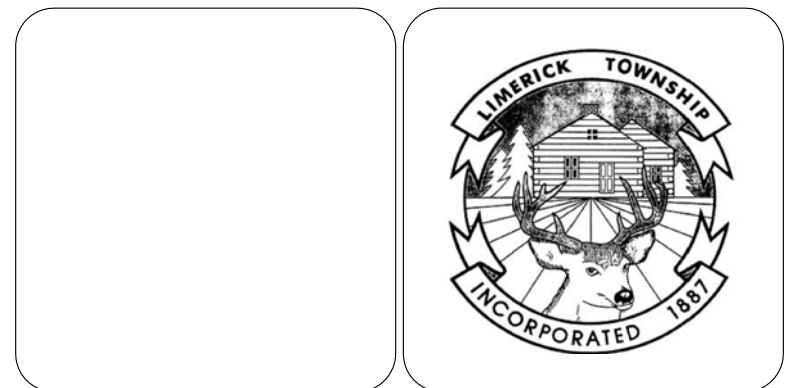

G.D. JEWELL ENGINEERING INC.
CONSULTING ENGINEERS

KINGSTON	BELLEVILLE	MISSISSAUGA
TEL: (613) 396-7250 FAX: (613) 396-2754 Email: kgymon@jewelleng.ca	TEL: (613) 966-1111 FAX: (613) 966-6966 Email: hld@jewelleng.ca	TEL: (905) 855-1502 FAX: (905) 855-5428 Email: hld@jewelleng.ca
TOLL FREE 1-800-966-4338 www.jewelleng.ca		

**TOWNSHIP OF LIMERICK
REHABILITATION
STEENBURG LAKE ROAD NORTH**



Drawn by: CCG	Project No: 150-3794
Designed by: CB	Date: MARCH 2016
Checked by: CB	Scale - Hor: 1:500 Vert:
Approved by: CB	Contract No: Drawing No: 14